



Exchange account (Corporate Sync) is for Microsoft® Exchange server e-mail accounts.

Password: <Your Wesley password>
Server: m.outlook.com **or**
 pod51000.outlook.com
Proxy: <Leave Blank>

Gingerbread Instructions

- From the home screen tap  > **My accounts > Add Account > Corporate sync.**
 *Note – Older Android models might show “Exchange Activesync” as an option, if so, select that and proceed.
- Enter your full e-mail address & password. If your Exchange Server does not support auto-detect, you’ll need to enter your Exchange Server settings. The settings will be listed below.
 Tap the menu key  and select **set up manually**



Android 4.0 (Ice Cream Sandwich) Instructions

- From the home screen touch  > **Settings > Accounts & Sync**

- On the next screen, additional fields will be displayed. Enter the details below:

E-mail Address:
 Firstname.Lastname@email.wesley.edu
Domain: <Leave Blank>

2. Tap **Add Account > Corporate**

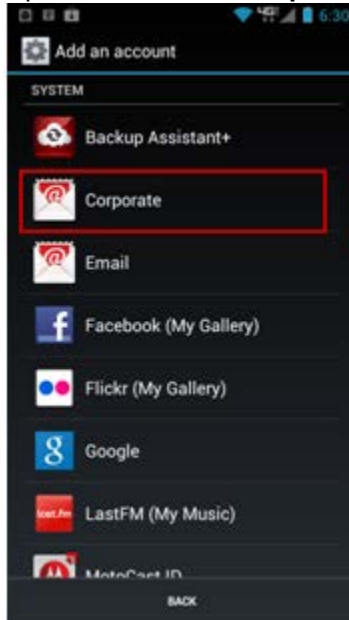

Tap **Next**.

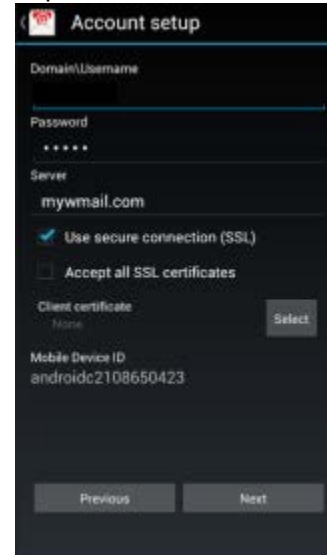

3. Enter your e-mail address and password and tap **Next**.

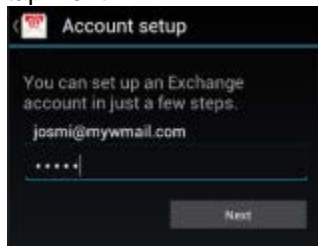

5. Tap to select the desired Account settings.

Once finished, tap **Done**.

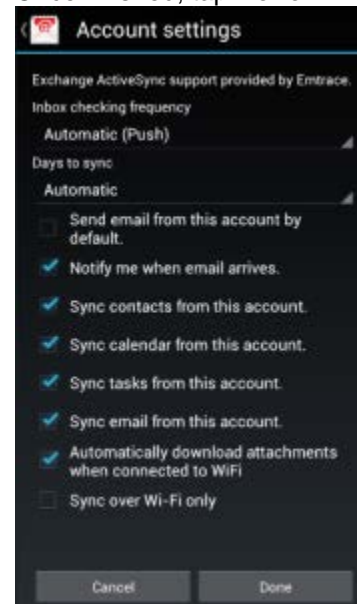

4. Enter the information as follows:

Domain\Username:

Firstname.Lastname@email.wesley.edu

Password: <Your Wesley Password>

Server: m.outlook.com **or**

pod51000.outlook.com

Use Secure Connection (SSL): Checked

Accept all SSL certifications: Checked

6. Enter a name for the account and then tap

Next.

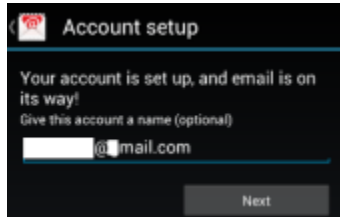

The Microsoft Exchange ActiveSync account is now set up.